

# GMP RF

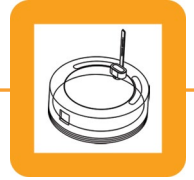

## Real Time Temperature Data Logger -90 to +140°C



- + Collects and transmits real time temperature to XpertLog Software
- + ITS-90 calibration coefficients are stored in the internal memory
- + Complies with FDA 21 CFR Part 11
- + Network ready: multiple users, centralized, server database, active directory authentication
- + Can be remotely activated

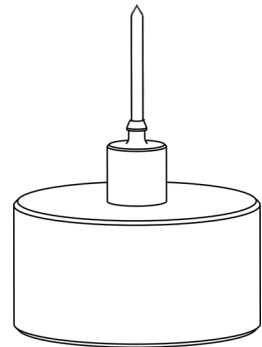
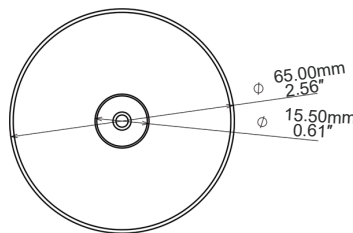
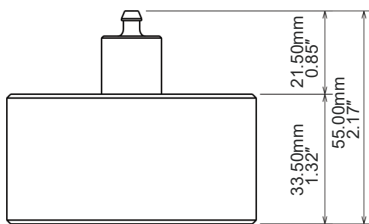

Sensor type	4 wires PT-100
- rigid	20 mm (0.8") / 150 mm (6")
- customized	available
- sensor size	1.5 x 8 mm (0.06 x 0.315")
- cross section	1.77 mm <sup>2</sup> (0.0027 inch <sup>2</sup> )
Operating Range	
- body temp.	-90°C to +140°C
- sensor temp.	-90°C to +140°C
Accuracy	±0.1°C from -90 to +140°C
Resolution	0.01°C
Memory capacity	32,000 data points
Sampling rate	1 sec to 24 hours
Transmission	Simultaneous: maximum 20 loggers Sequential: unlimited
Internal clock Drift	4 sec / 24 h @ + 23 °C
Mechanical	
- material	Peek 1000 - FDA compliant
- enclosure	IP-68
- weight	115 g (4.06 oz)
- diameter	65 mm (2.56")
- height	55 mm (2.17")
Power	2 x Lithium batteries, 0.35 g/each content classified UN3091 under IATA DGR section 3.9.2.6 compliant with ICAO/IATA packing instruction 970 user replaceable
Battery lifetime	Up to 6 months, based on usage
Antenna	Internal
Wireless range	121 m (400')
Radio frequency	2.4 GHz ISM band
Access point	USB to computer
Calibrations	Programs and reads unlimited number of loggers Factory: Traceable NIST / COFRAC - ITS-90 coefficients reside in the internal memory User: Closed loop user calibration, using XpertLog® Software
Certification	EMC: EN 60601-1-2 / 2007 RF: EN 300440-2 v1.3.1 (2009-03) Health & Safety: EN 60950-1/2006

Order Reference:  
GMP\_RF

### Standard Calibration Points

- -80°C
- 0°C
- 140°C

