

# GDP RH

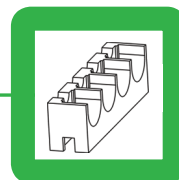

## Standard Humidity Data Logger 15 to 95% RH



- + Collects and stores humidity and temperature information in the internal memory
- + Recover the data through the docking station using XpertLog Software
- + ITS-90 calibration coefficients are stored in the internal memory
- + Complies with FDA 21 CFR Part 11
- + Network ready: multiple users, centralized, server database, active directory authentication

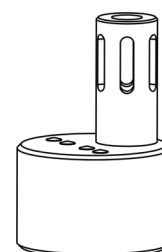
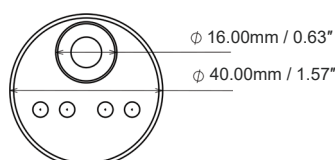
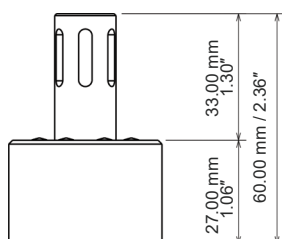

Sensor type	RH: capacitive / Temp: 4 wires PT-100
- fixed	20 mm (0.8")
- temp. sensor size	1.5 x 8 mm (0.06 x 0.315")
- temp. cross section	1.77 mm <sup>2</sup> (0.0027 inch <sup>2</sup> )
Operating Range	
- humidity	15% to 95% RH
- body temp.	-40°C to +85°C
- sensor temp.	-40°C to +85°C
Accuracy	±2.0% RH @ +23°C (15-60% RH)
	±3.0%RH @ +23°C (60-95% RH)
	±0.1°C from -40 °C to 85 °C
Resolution	0.01% RH
Memory capacity	16,000 data points RH / 16,000 data points temperature
Sampling rate	1 sec to 24 hours
Internal clock Drift	4 sec / 24 h @ + 23 °C
Mechanical	
- material	POM-C; FDA compliant
- enclosure	IP-51
- weight	45 g (1.58 oz)
- diameter	40.0 mm (1.57")
- height	60.0 mm (2.36")
Power	1 x Lithium battery, 0.35 g Lithium content classified UN3091 under IATA DGR section 3.9.2.6 compliant with ICAO/IATA packing instruction 970 user replaceable
Battery lifetime	Up to 12 months, based on usage
Docking station	USB to computer
	4, 8, 12 and 20 ports available
Calibrations	Factory: Traceable NIST / COFRAC - ITS-90 coefficients reside in the internal memory
	User: Closed loop user calibration, using XpertLog® Software
Certification	EMC: EN 60601-1-2 / 2007
	Health & Safety: EN 60950-1/2006

Order Reference:

GDP-RH

### Standard Calibration Points

- 25° C / 20%RH
- 25° C / 45%RH
- 25° C / 65%RH
- 25° C / 75%RH

Upon special request:

- 25° C / 90%RH

